

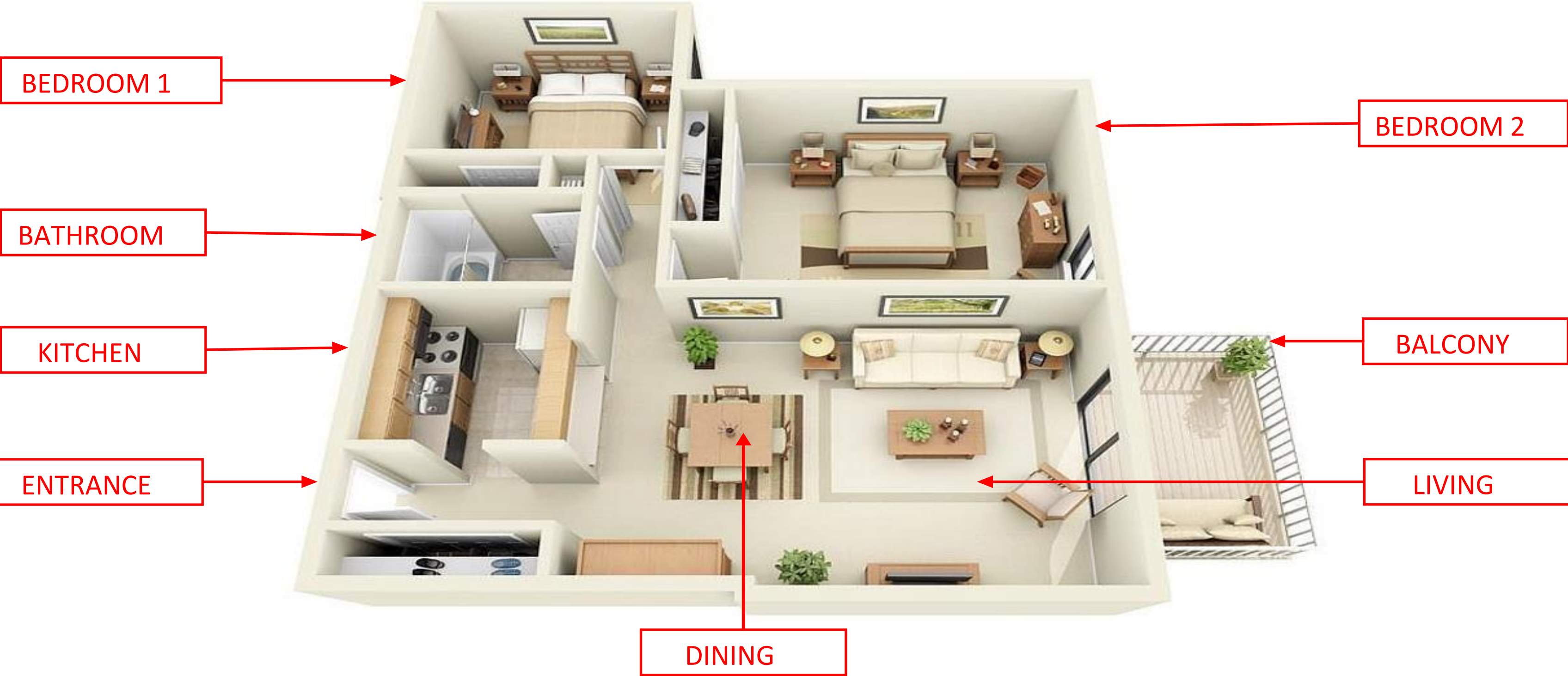

SMART AUTOMATION



Wi-Fi Home Automation for 2 BHK Apartment



SMART AUTOMATION USER INTERFACES



SMART APP

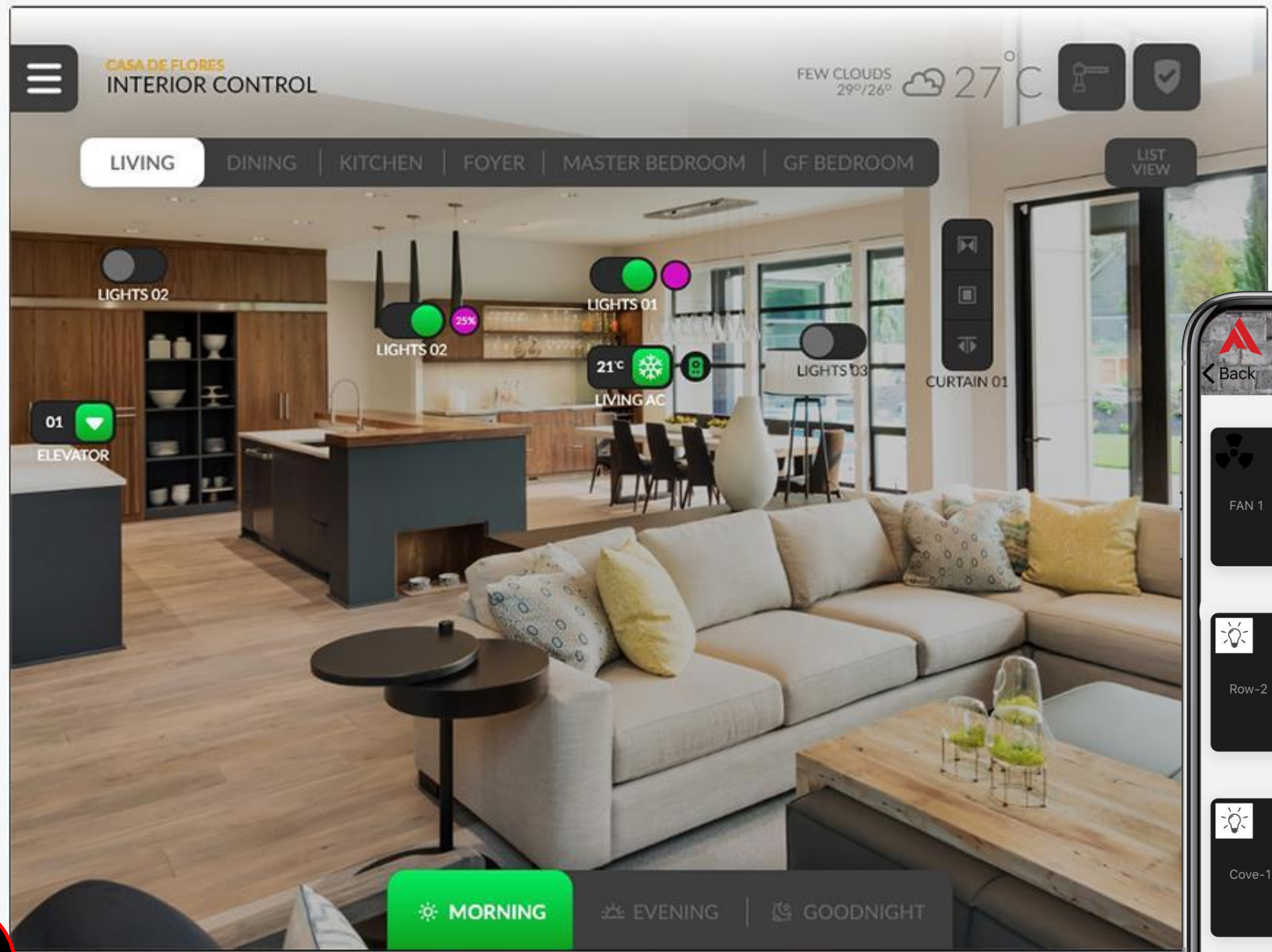

Control by App



VOICE ASSISTANT



- Turning electrical devices ON/OFF - lights, fans, AC, TV, STB, Water Heater
- Dimming Lights with phase cut drivers (LEDs)
- Color change of LED Strips (using RGB; RGB-W)
- Changing Fan speed
- Changing AC temperature setting & fan speed
- Changing TV Channels on STB
- Moving curtains open or closed
- Creating 'Profiles' that allow a combination of devices to be operated by a single button on the Smart App - like 'All ON', 'All OFF', 'Movie Time', 'Good Night'
- Creating schedules for automatic operation of individual switches or complete profiles, (e.g. curtain opening in AM and closing in PM)



AIT SYSTEM OVERVIEW

- A Wi-Fi Home Automation System comprises of Wi-Fi nodes and a Wi-Fi IR node.
- AIT Nodes sits behind and connects to any standard module switch in order to control the electrical load connected to the switch. The node can communicate with the Wi-Fi router directly to receive control signals and to send status signals.
- The node can communicate via Wi-Fi with the router in the home.
- Usually, single Wi-Fi router can manage the nodes throughout the home, but it depends on the layout of walls in the home.
- The users can use the AIT Smart App on mobile/Tab or Voice Assistants to operate
- lights, fans, TV, STB and Curtains or to initiate 'Profiles'



SYSTEM ARCHITECTURE

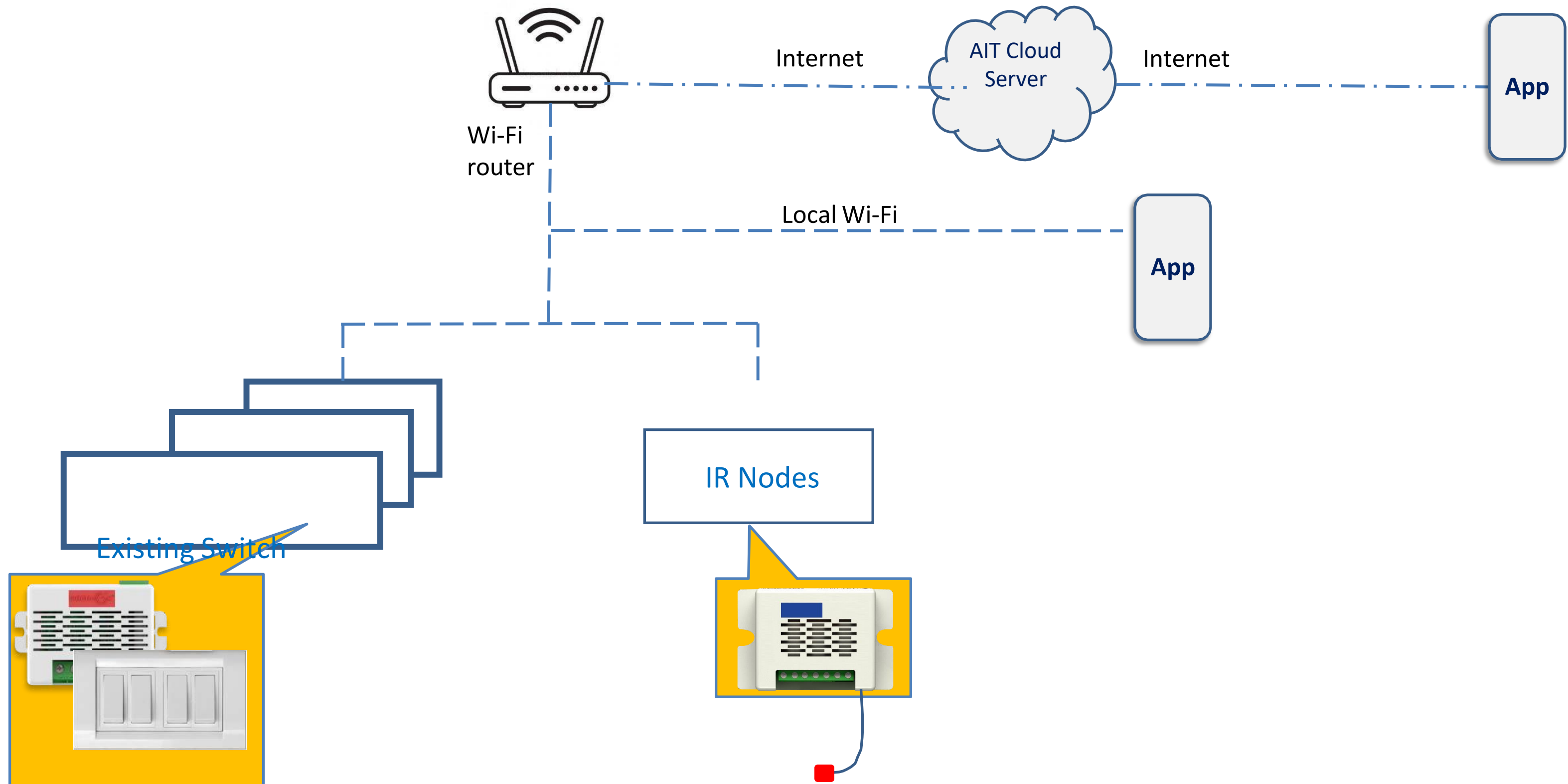

In this apartment, only some Switch Panels were Automated, but not all. They are described below. Also, some items (e.g. Curtain Control, sensors) which were not present earlier were added.

ENTRANCE

- Converted to Smart Automation:**
- 1 Switch panel with
 - 1 Light & Smart Lock

LIVING AREA

- Converted to Smart Automation**
- 1 Switch Panel with
 - 1 Fan switch w/ regulator
 - 2 Lights
 - 1 Cove Light Dimmer
 - 1 AC control (both power ON/OFF and IR control)
 - 1 TV and STB control (IR control only)
- Additions for Smart Automation**
- 1 Curtain motor for control (app/voice only – no switches)

DINING AREA

- Converted to Smart Automation**
- 1 Switch Panel with
 - 1 light
 - 1 Cove light Dimmer
 - 1 AC control (both power ON/OFF and IR control)

KITCHEN

- Converted to Smart Automation**
- 1 Existing Switch panel for
 - Light Switch
 - Exhaust Fan

BEDROOMS (2)

- Converted to Smart Automation**
- 1 Switch Panel with
 - 1 light (2-way, with sister switch in bedside panel)
 - 1 fan switch w/ regulator
 - 1 AC control by SA (both power ON/OFF and IR control)
- ADDITIONAL COST:**
- Panic buttons
 - Motorized curtains
 - Smart Mirrors

BATHROOMS (2)

- Converted to Smart Automation**
- 1 switch panel for water heater (high capacity)
 - 1 wired motion sensor to the light switch

BALCONY

- 1 Switch panel for
 - Light Switch

Items not Automated across these rooms

- There were multiple switch + socket combos either in isolation or part of above panels that were not part of Automation

